

# Introducing "EDDIE"

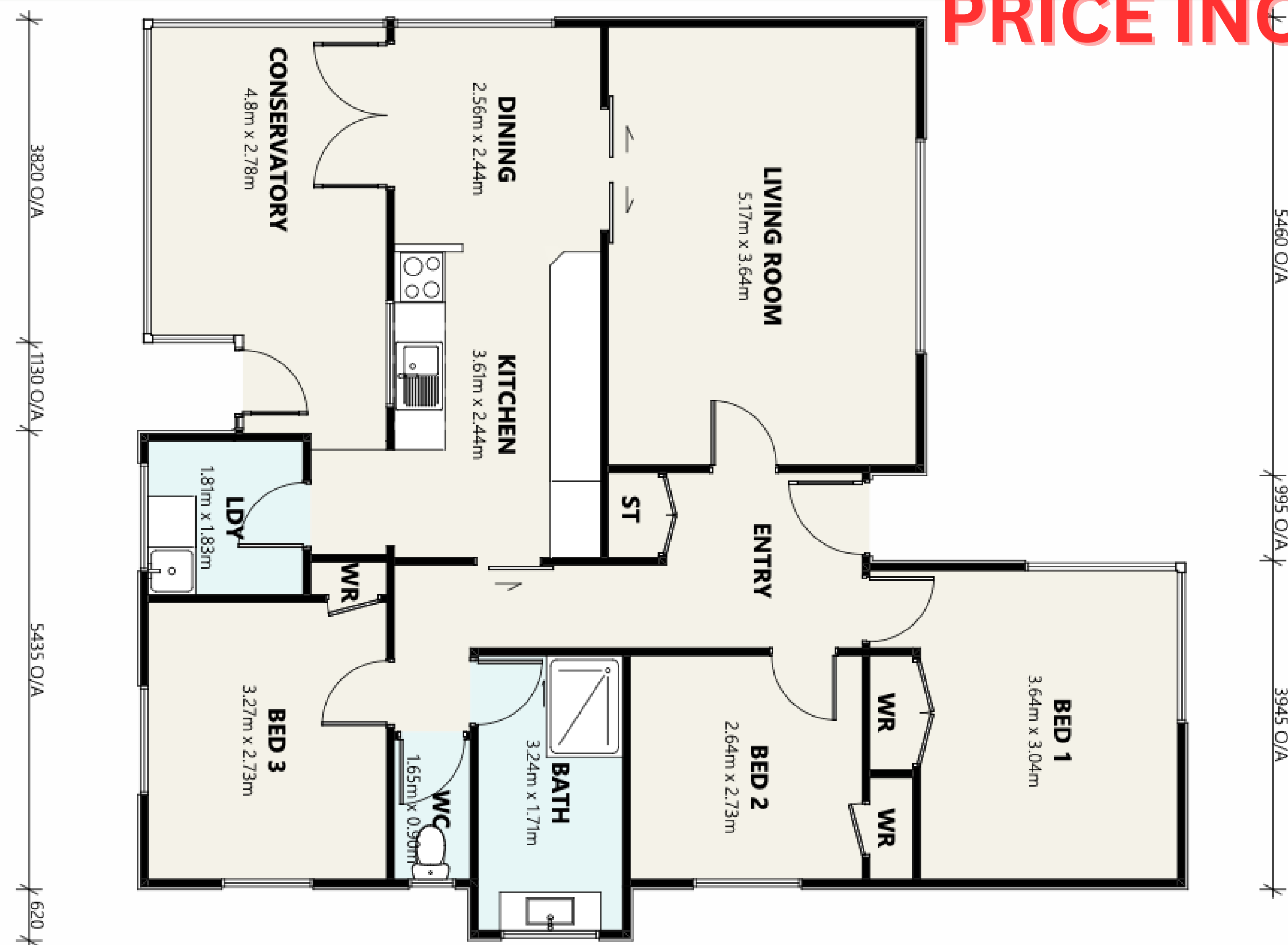

**CRAIG WALKER**  
BUILDING REMOVALS LTD

**PRICE INCLUDES NEW EXTERIOR PAINT**



DRAWING FOR MARKETING PURPOSE ONLY - NOT TO SCALE  
PLEASE REQUEST SCALE 1:100 @ A3 for PLANNING

**\$132,250.00 GST INC RESITED : Conditions Apply**

**3 BRM - 105.7 SQM**